

## Twin Stud - Fire Rating 2 Hours (CWS-1)

### Description

Frame : JayaBMS Wall Track, JayaBMS Deflection Head Track, JayaBMS C Stud

Lining : 2 layers of USG Boral Firestop 16mm (both sides)

Weight :  $\pm 54 \text{ kg/m}^2$

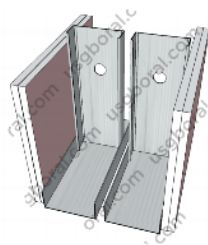

STUD SIZE (mm)		MAXIMUM HEIGHT (mm) Non-Load Bearing Studs			WALL THICKNESS (mm)	FIRE RATING (minutes)	ACOUSTIC RATING (STC)	
Width	Thickness	@600mm centres	@400mm centres	Grade BS 5234			Without Insulation	Insulation Mineral Wool 50mm
64	0.5	3150	3650	Severe Duty	212	120	55	71
	0.7	3550	4200			120		
76	0.5	3600	4300		236	120	56	72
	0.7	4150	5100			120		
92	0.5	4350	5350		268	120	57	72
	0.7	5150	6550			120		
100	0.5	4750	6000		284	120	58	72
	0.7	5750	7350			120		
150	0.7	8800	10050	384	120	60	72	