

## Fire Rating 2,5 Hours - Optimum (SS-2)

### Description

Frame : JayaBMS Wall Track, JayaBMS Deflection Head Track, JayaBMS C Stud

Lining : 2 layers of USG Boral Firestop 16mm (both sides)

Weight : ± 53 kg/m<sup>2</sup>

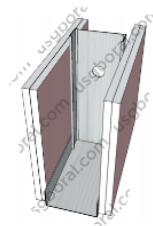

STUD SIZE (mm)		MAXIMUM HEIGHT (mm) Non-Load Bearing Studs			WALL THICKNESS (mm)	FIRE RATING (minutes)	ACOUSTIC RATING (STC)	
Width	Thickness	@600mm centres	@400mm centres	Grade BS 5234			Without Insulation	Insulation Mineral Wool 50mm
64	0.5	4050	4250	Severe Duty	128	150	49	58
	0.7	4200	4500			150		
76	0.5	4600	4900		140	150	50	59
	0.7	4850	5250			150		
92	0.5	5450	5900		156	150	51	59
	0.7	5800	6200			150		
100	0.5	5950	6250		164	150	51	59
	0.7	6200	6550			150		
150	0.7	7600	8350		214	150	53	59