



Latest Suspended Ceiling System Technology

DONN® DX II®

Seismic rated, fastest installation and removal without tools

Features and benefits

- * World most advanced manufacturing facilities and technology ensure highest grid quality.
- * Grid capping without colour variance, excellent matching with USG mineral ceiling tiles.
- * Exclusive steel galvanisation coating system on grid components resist corrosion and rust.
- * Cross tee with override-ends resists twisting and give a professional finished look with no exposed steel edges.
- * Patented DX II cross tee clips are easy to remove without tools, fast to install, ensure grid module squareness and firmness.
- * Comply with China GB 11981-89, ASTM C 635 and ASTM E 580 standards.



1.
This improved front edge detail reduces the force you need to insert the tee so you can install with less effort but without compromising stability. It also allows installation from top, level and below the grid. Ideal in tight or cramped conditions.

3.
The unique profiled flag shape gives a loud click on insertion and is designed to prevent snagging on the main tee web. So installer can count on the clip being positively located.

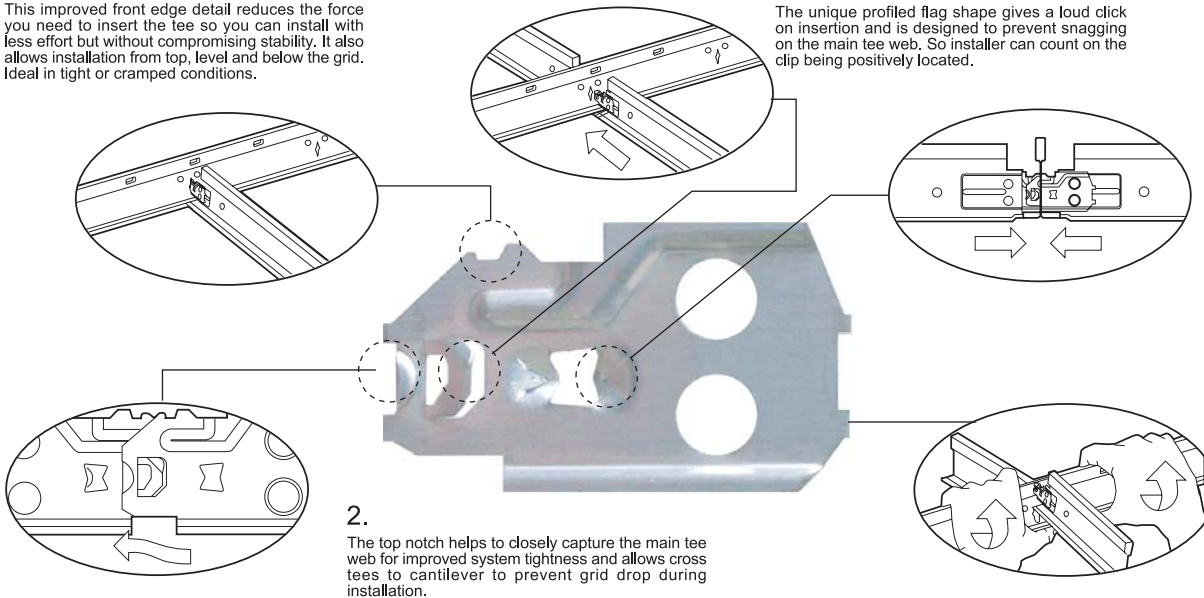

4.
High clip-to-clip locking tolerance produces one of the strongest and tightest tee/tee connections ever keeps the whole system straight and square.

5.
Patented clip design- just twist and the tees are released. No tools needed.

1. Easier installation
DONN® DXII® leads the industry with up to 40% less insertion force required. This decreases the amount of installation work and saves you time.

2. Consistent insertion force
The DONN® DX II® cross tee insertion force variation is only ±2lbs., thus it allows for repetitive, predictable and faster installation. Installer does not have to struggle with installation.

3. Easier removal without tools
When it comes to changes or errors during installation, the DONN® DX II® cross tees can be easily removed by rotating or twisting the cross tee / main tee intersection.

4. Multiple cross tee installation angles
The DONN® DXII® cross tee can be installed speedily from top, level and below in areas with low plenum, or with plenum obstructions and varying ceiling heights.

5. Seismic rating
In compliance with ASTM E 580 4.1.2

6. Tight and square grid modules
The DONN® DX II® patented clip design provides close locking tolerance for tight module control and clean square lines. This is ideal for large or small ceiling areas

7. Faster installation
The unique profiled flag shape gives a loud click on insertion, so installer can count on the clip being positively located.

8. Cross tee cantilever
The patented top notch safety design helps to closely capture the main tee web for improved system tightness and allows cross tees to cantilever to prevent grid drop during installation.

9. Cross tee clip-to-clip locking tolerance
The new improved high tolerance clip-to-clip locking design produces strongest and tightest tee / tee connections ever, with pull out strength of more than 300 lbs. This feature will ensure the whole system is straight and square.





DONN® DX II®

Technical performance

Product Component	Unit	Item Code No.	Length mm / ft	Height mm	Capping Width mm	Packaging Quantity carton
Main Tee	Metric	DX II 3600 HM	3600	38	24	25
	Imperial	DX II 3660 HM	3660	38	24	25
Cross Tee	Metric	DX II 1200 LM	1200	25	24	50
	Imperial	DX II 1220 LM	1220	25	24	50
	Metric	DX II 600 LM	600	25	24	75
	Imperial	DX II 610 LM	610	25	24	75
Wall angle	Metric	MT 3000	3000	NAL	21 X 21	50

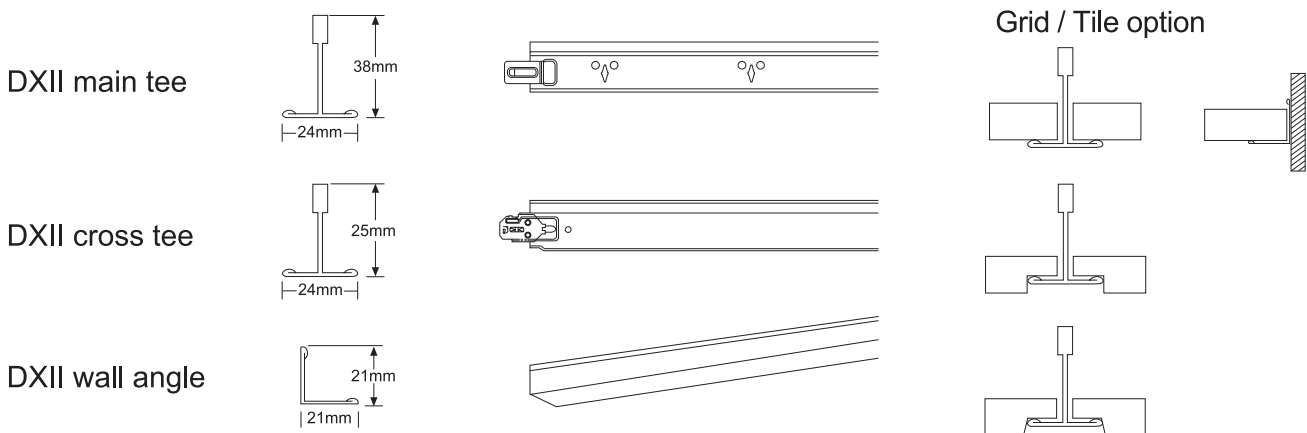

Uniform Loads-kg/lm (linear metre)

Load test data shows uniform load in kg/lm based on simple span test in accordance with ASTM C635 deflection limit on L/360

DONN® DX II® component	Uniform Load kg/lm
Main tee @ 1.2m O.C.	15.65
Cross tee @ 1.2m O.C	9.68

Tee connection values

Connection values shows in accordance with ASTM E580 (Standard Practice for Application of Ceiling Suspension Systems for Acoustical Tile and Lay-in Panels in Areas requiring Moderate Seismic Restraint)

Intersection type	Height mm	Tension lbs/LF	Compression lbs/LF
Main tee splice	38	204	489
600mm cross tee connection	25	434	238
610mm cross tee connection	25	434	238
1200mm cross tee connection	25	434	238
1220mm cross tee connection	25	434	238



DX II / 07

